

0660-001
134

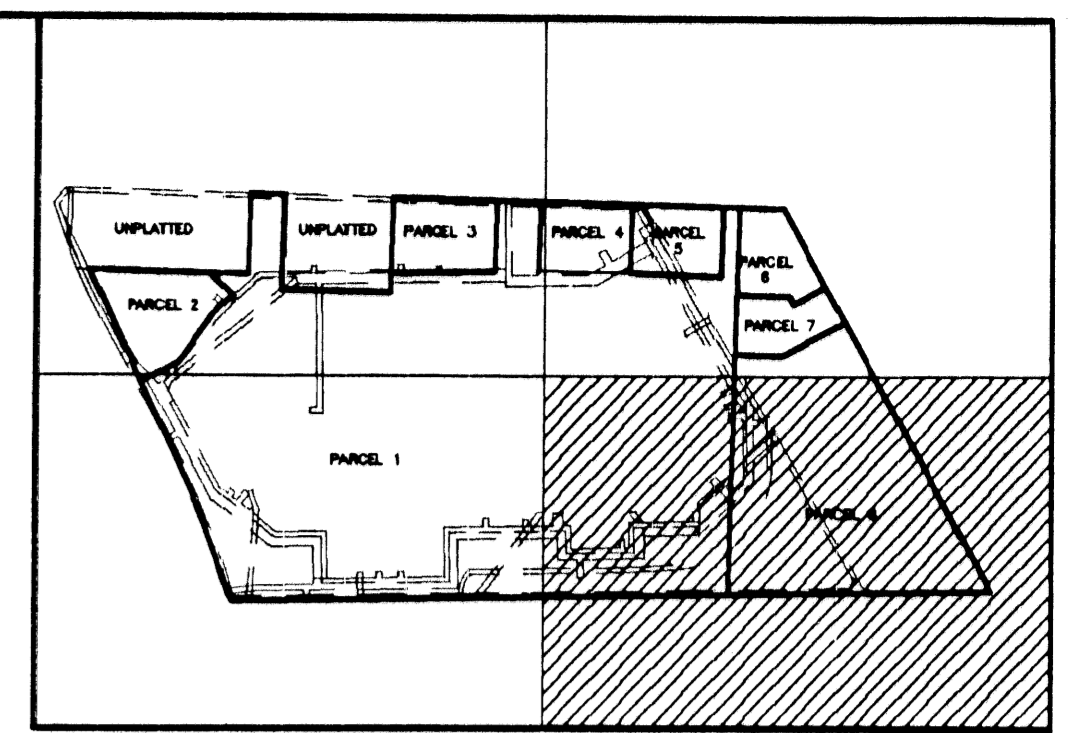

INDEX MAP

PARCEL 7

PARCEL 1

SEE SHEET 4 OF 6

PINEWOOD SQUARE

BEING A PORTION OF TRACT 39 OF THE HIATUS TOWNSHIP
44 1/2 SOUTH, RANGE 42 EAST, PALM BEACH COUNTY, FLORIDA
AUGUST 1998 SHEET 6 of 6

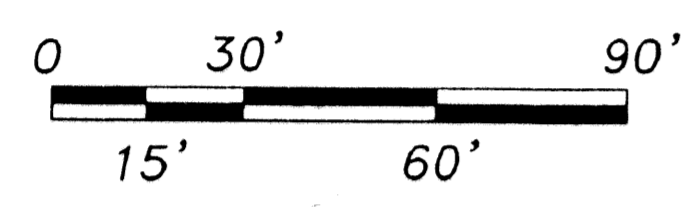
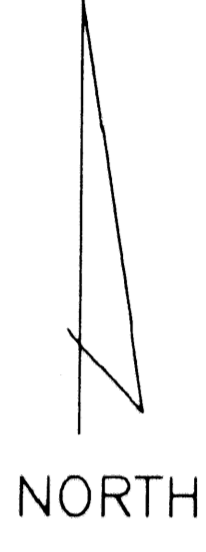

MATCH LINE

SEE SHEET 5 OF 6

MATCH LINE

PLAT BOUNDARY

PARCEL 8

12' WATER / SANITARY SEWER UTILITY EASEMENT ORB 5720 PAGE 1872

WATER & SANITARY SEWER EASEMENT #18 ORB 5720 PAGE 1872

POINT OF BEGINNING DESCRIPTION No. 11 ORB 5720, PAGE 1872 ALSO: FPL EASEMENT ORB 5711, PAGE 1924

12' WATER / SANITARY SEWER UTILITY EASEMENT ORB 5720 PAGE 1872

POINT OF BEGINNING DESCRIPTION No. 18 ORB 5720, PAGE 1872 ALSO: FLORIDA PUBLIC UTILITIES EASEMENT ORB 5439, PAGE 14

WATER / SEWER EASEMENT #4 ORB 5720 PAGE 1872

10' WATER / SANITARY SEWER EASEMENT #8 ORB 5720 PAGE 1872

PLAT BOUNDARY

PARCEL 1

RECORD EASEMENTS

OFFICIAL RECORD	BOOK	PAGE	BENEFICIARY
5720	1872		PALM BEACH COUNTY
5439	14		FLORIDA PUBLIC RECORDS
5711	1924		FPL

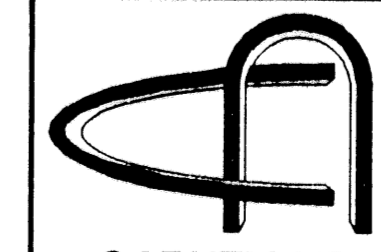

CARNEY-NEUHAUS, INC.
LB6770

11911 U.S. HIGHWAY 1, SUITE 120
PALM BEACH GARDENS, FL 33408
TEL: (561)622-1300
FAX: (561)622-1428

1674 MERIDIAN AVENUE, SUITE 307
MIAMI BEACH, FL 33139
TEL: (305)534-8622
FAX: (305)534-5507

4101 N. ANDREWS AVE., SUITE 213
FORT LAUDERDALE, FL 33309
TEL: (954)565-0530
FAX: (954)565-3924

DATE	REVISIONS	FIELD:	JOB:	FB:
		DRAWN: MB	DATE:	SCALE: 1"=30'
		CKD, DOC	DWG.	

SUBDIVISION: Pinewood Square
 PAGE: 134
 BLOCK: 84
 PLAT: 134
 ZONING: CE 15E
 CE 15E
 ZIR CODE: 33407
 PLAT NAME: Pinewood Square